



YLI ELECTRONIC

Double Bolt Motor Driven Electric Lock



Model: YB-1600DMD(LED)

Introduction

The Mute Electric Lock for Elevator is locked and unlocked by the activity of the bolt which is driven by the stepping motor. The stepping motor has great strength, the powerful thrust of the stepping motor can be used to push the bolt to align the door to achieve the purpose of locking when the door is deformed or skewed. All parts are made of metal material, the mechanical structure of inserting and resetting has been treated with noise reduction. The two Hall components on the PCB board can accurately locate and control the stretch out and draw back of the bolt, so that unlocking and locking can be muted. Compared with the traditional electric bolt using solenoid valve structure, when the product enters the locking and unlocking state, there is no need to power the motor continuously, low energy consumption and environmental protection. The lock is equipped with an emergency triangle unlocking device which can be used to unlock in case of emergency.

Specifications

Dimensions of Lock	260Lx30Wx53H(mm)
Dimensions of Door Contact	13 (diameter)x11H(mm) (Default double door installation)
Dimensions of Strike Plate	160Lx25Wx3H(mm) (Strike plate for single door can be ordered)
Dimensions of Latchbolt	14mm(prolongation)x16mm(diameter)304 stainless steel high strength solid bolt
Signal Output	Door signal(NO/COM);Lock signal(NO/NC/COM) Electronic Induction(Default)
Voltage	12 ~ 28 VDC
Start Current	800mA
Standby	≤50mA
Time Delay	0/3/6/9sec Adjustable
LED	Red shows locked;Green shows unlocked
Detection Distance	≤8mm
Suitable for	metal door, glass door
Material	304 stainless steel, wire draw finishing
Weight	1kg
Patent Number	202222451683.5 202222452053.X

Dimensions

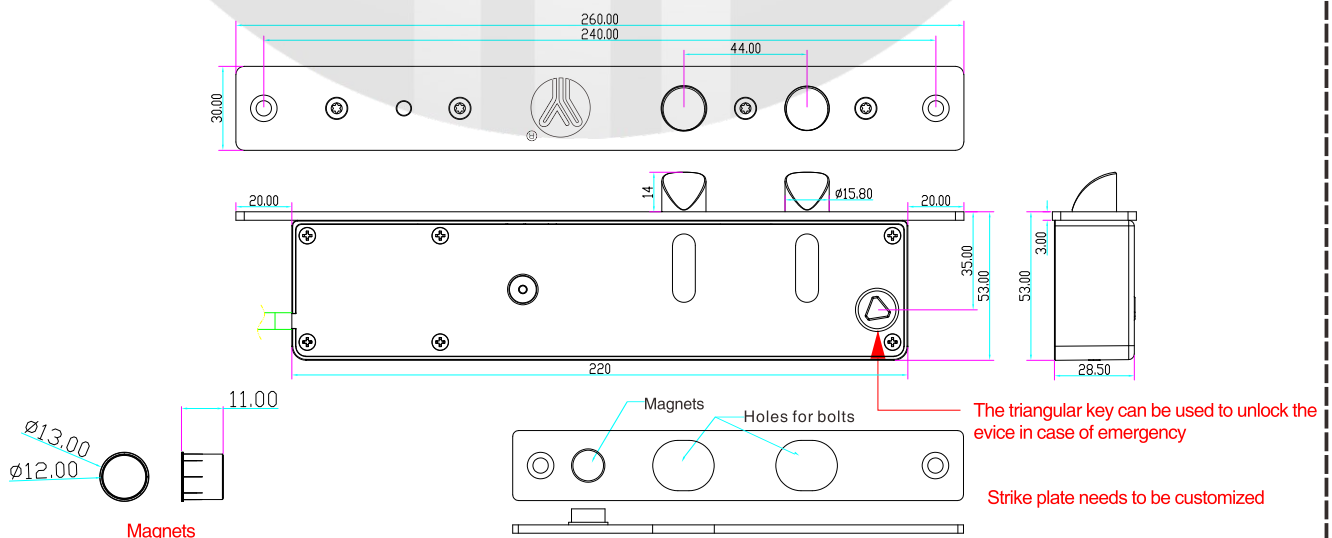

Functional Characteristics

1. Use the emergency triangle key to unlock, the bolt can be reset automatically after unlock.
2. Lock only when the OPEN wire contact (orange/black) is disconnected.
3. The lock signal output works only when the bolt is fully inserted.
4. When the bolt meets resistance, it will automatically restart for three times before stopping to protect the motor.
5. Micro switch lock sensor output can be customized.
6. Emergency locking module can be customized (external), in the unlocked state, the bolt will automatically pop out when the power is cut off.

Time Delay

Adjust the delay time for locking automatically
0/3/6/9 secs.



0.0 SEC



6.0 SEC



3.0 SEC



9.0 SEC

Wiring Diagram

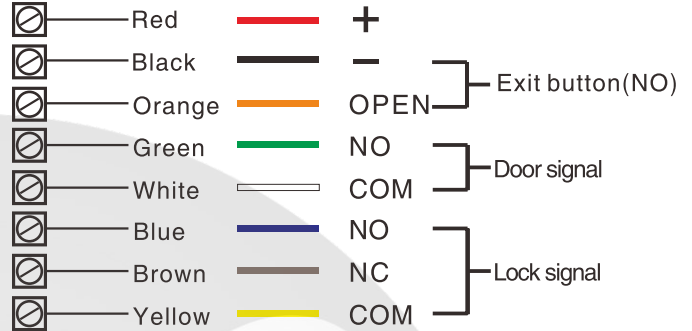

Bolt Reversing Operation Procedure

Please adjust the bolt according to the direction of opening the door

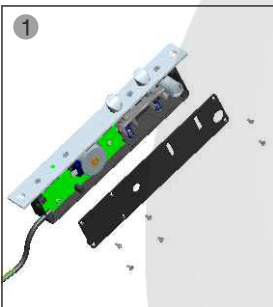

1
Unscrew the six screws on the cover plate and open.

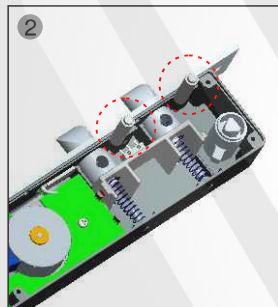

2
Remove the pin as shown.

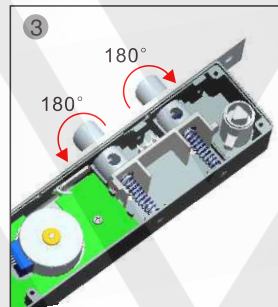

3
Turn the bolt 180 degrees

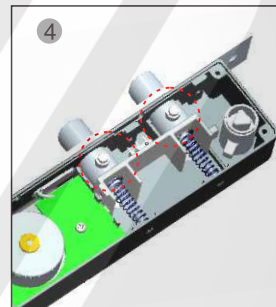

4
Insert the pin into the round hole of the bolt, align the oblong hole of the housing

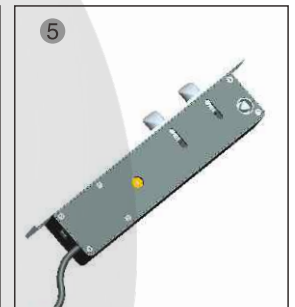

5
Assemble the cover plate and tighten the screws; press the bolt to test if it works smoothly

Installation Diagram

Horizontally installed on double door

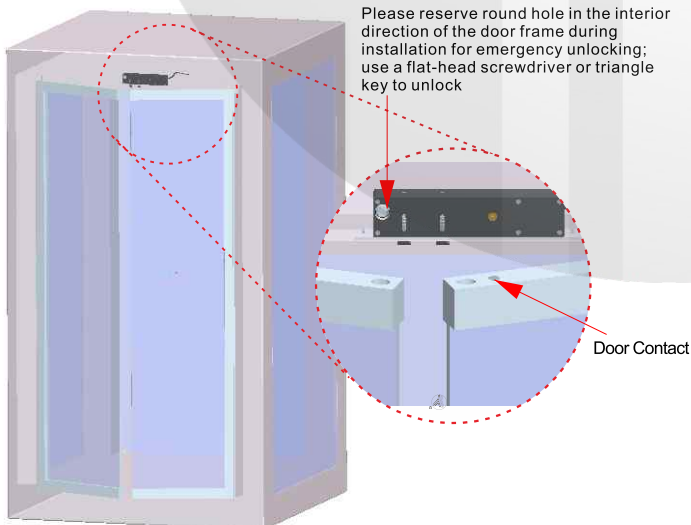

Vertically installed on single door

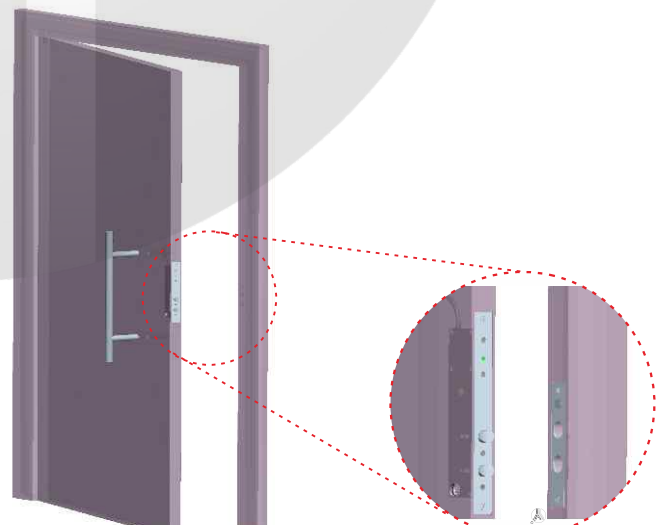

The template in the package should be used to locate the holes for door contact and bolts when install on double door.

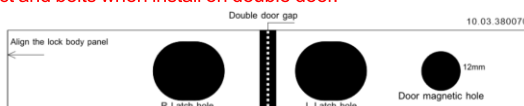

Template